



T13DA-RYZ-W-I

Analog 1310nm DFB Laser Diode, TOSA Receptacle

Description

The Lasermate T13DA-RYZ-W-I is an Analog 1310nm wavelength, Distributed Feedback (DFB) laser diode available in receptacle package with output power up to >2mW and isolator. The laser is designed for use in wireless and analog applications.



Features

- InGaAsP/InP MQW-DFB laser diode (LD)
- Data Rate: 155Mbps up to 2.5Gbps
- Uncooled operation at -20 to 85°C
- Hermetically sealed active component
- Built-in high performance, high speed InGaAs monitor PIN photodiode (PD)
- With single-stage isolator
- FC/ST receptacle package with 2-hole flange

Applications

- ATM/SONET OC-3/OC-12/OC-24
- SDH STM-1/STM-4/STM-8
- Gigabit Ethernet
- Wireless (CDMA, GSM, PCS) and Analog applications

Ordering Information

Read Model No.	T13DA-RYZ-W-I
T13DA = Laser	Analog 1310nm DFB laser
R = Package	Receptacle
Y = Connector	FC (FC); ST (ST)
Z = Output power	>1mW (H); >2mW (2)
W = Pin configuration	A pinout (A)
I = Isolator	With isolator (I)



Specifications

Absolute Maximum Ratings				
Parameters	Symbol	Value	Unit	Conditions
Storage temperature	Tstg	-40 to +85	°C	
Operating case temperature	Top	-20 to +85	°C	
Peak optical output power	Po	5	mW	
Forward current (LD)	I _{FLD}	100	mA	
Reverse voltage (LD)	V _{RLD}	2	V	
Reverse current (PD)	I _{RPD}	5	mA	
Reverse voltage (PD)	V _{RPD}	15	V	
Soldering temperature	Stemp	260	°C	10 seconds

Electro-Optical Characteristics (CW @ T _c = 25°C unless otherwise noted)						
Parameters	Symbol	Min.	Typ.	Max.	Unit	Conditions
Central wavelength	λ_c	1300	1310	1320	nm	CW, Pf
Side mode suppression ratio	SMSR	30	40	-	dB	Pf
Spectral width	$\Delta\lambda$	-	0.2	1	nm	Pf
Threshold current	I _{th}	-	10	15	mA	CW
Fiber output power	Pf	1.0			mW	CW, I _f =I _{th} +20mA
		2.0				
Operating voltage	V _{op}	-	1.1	1.5	V	Pf
Rise time / Fall time	t _r /t _f	-	0.1	0.2	nsec	I _b = I _{th} , 20%~80%
Monitor current	I _m	100	-	1000	uA	Pf, V _{rp} =5V
Monitor dark current	I _d	-	0.1	100	nA	V _{rp} =5V
Monitor capacitance	C	-	10	20	pF	V _{rp} =5V, f=1MHz
Relative intensity noise	RIN	-	-154	-145	dB/Hz	CW, P _{op} =2.0mW, f=2200MHz
Second-order intermodulation	IMD2	-	-	-45	dBc	Two-tone, OMI=20%/tone, f=2200MHz & 2202.5MHz
Third-order intermodulation	IMD3	-	-	-56	dBc	Two-tone, OMI=20%/tone, f=2200MHz & 2202.5MHz
Tracking error*	$\Delta Pf / Pf$	-	±1.0	±1.5	dB	APC, T _c =-40~+85°C

*I_m=constant @ Pf, T_c=25 °C

Outline Dimensions (unit: mm)

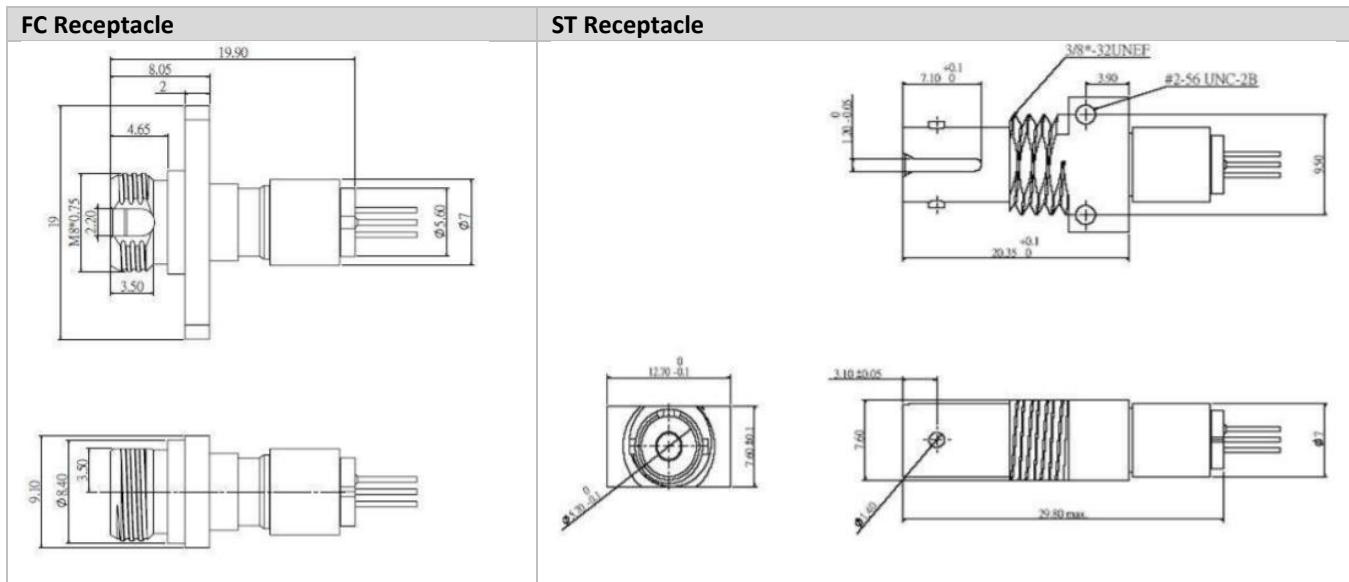

Pin Assignment

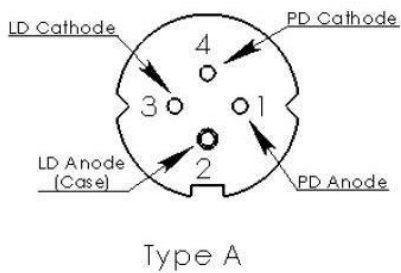

Pin Number	Type A
1	PD Anode
2	LD Anode (case)
3	LD Cathode
4	PD Cathode

Additional Notes

- Avoid eye or skin exposure to laser radiations.
- The device is sensitive to electro-static discharge (ESD). The device should be handled with ESD proof tools. To assemble the device on PCB, proper grounding is required to prevent ESD.
- Specifications are subject to change without notice.